

Clearance Publish

Clearance = 100mm



Clearance Computation Specification

Products Selected

Clearance Computation Specification		
Products Selected		
ATCNSE_0004 - DRAIN PIPE FOR - LAR END-CAP CALORIMETER	AT392169MQ - TOP LEVEL ACCESS PLATFORMES - SECTOR 13	Contact
	VHB_0001 - CENTRAL PAIR OF FEET B - DETAILED MODEL FOR STANDARDS	47.3
	NLE_0002 - LE END-CAP CALORIMETER - SIDE A	13.7

Computation Result:

Products Selected		
NSE__0004 - DRAIN PIPE FOR - LAR END- CAP CALORIMETER	AT602161MQ - MUON BARREL CHAMBERS DETAILED - SECTOR 11	92.1
	AT602165MQ - MUON BARREL CHAMBERS DETAILED - SECTOR 13	16.3
	NMC__0019 - MEE CHAMBERS SIDE C - 3D SIMPLIFIED MODEL	15.5
	NMA__0007 - BARREL PROJECTIVE ALIGNMENT. - SIMPLE 3-D MODEL SECTOR 13	2.3
	NMA__0016 - SECTOR 12 SIDE C (A) - REFERENCE ALIGNMENT SYSTEM AND	99
	NSB__0008 - BARREL LAR BOTTOM FT VACUUM LINES - SIMPLIFIED 3D OBJECT	49.5
	NSR__0005 - CABLE TRAYS - FOR TB VACUUM PUMPING SYSTEM	72
	NTB__0003 - TB WARM STRUCTURE - SIMPLIFIED 3-D OBJECT	49.7
	NTB__0005 - TB WARM STRUCTURE - RING OF THE VOUSOIRS, STRUTS	77.7
	NTB__0002 - TB FEET COIL - SECTOR 12	6



Clearance Publish

Clearance Computation Specification	
Products Selected	
NSE_0004 - DRAIN PIPE FOR - LAR END-CAP CALORIMETER	AT392169MQ - TOP LEVEL ACCESS PLATFORMES - SECTOR 13

Computation Result:

NSE__0004	AT392169MQ	Contact	Not inspected
-----------	------------	---------	---------------

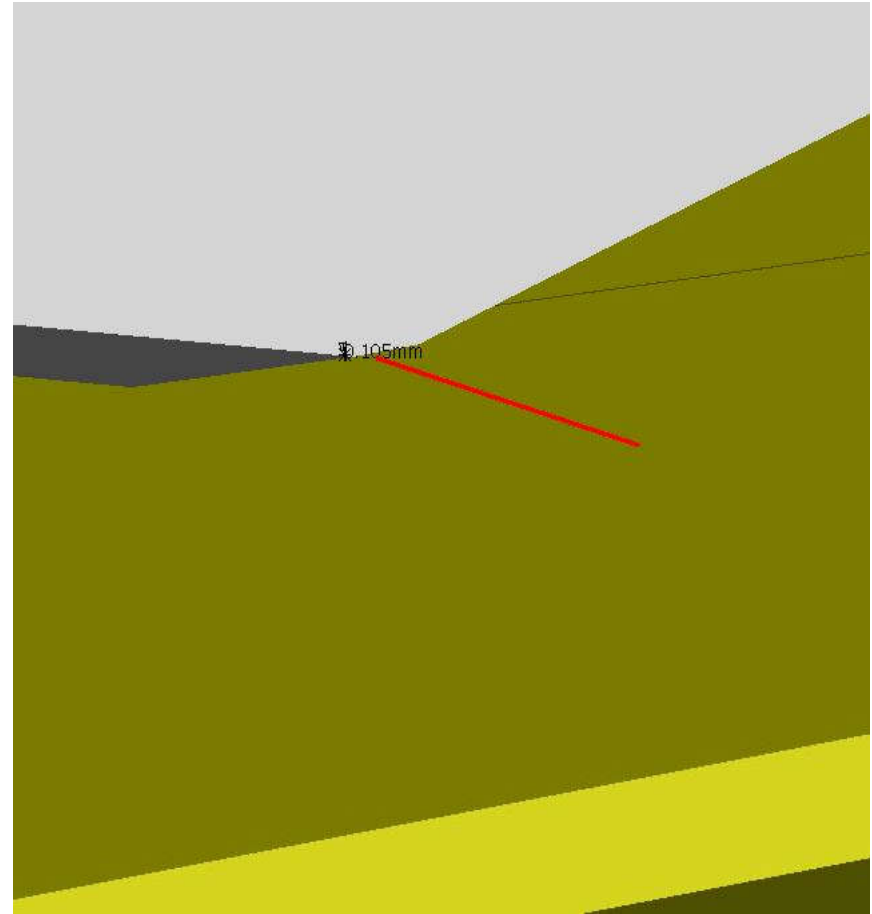
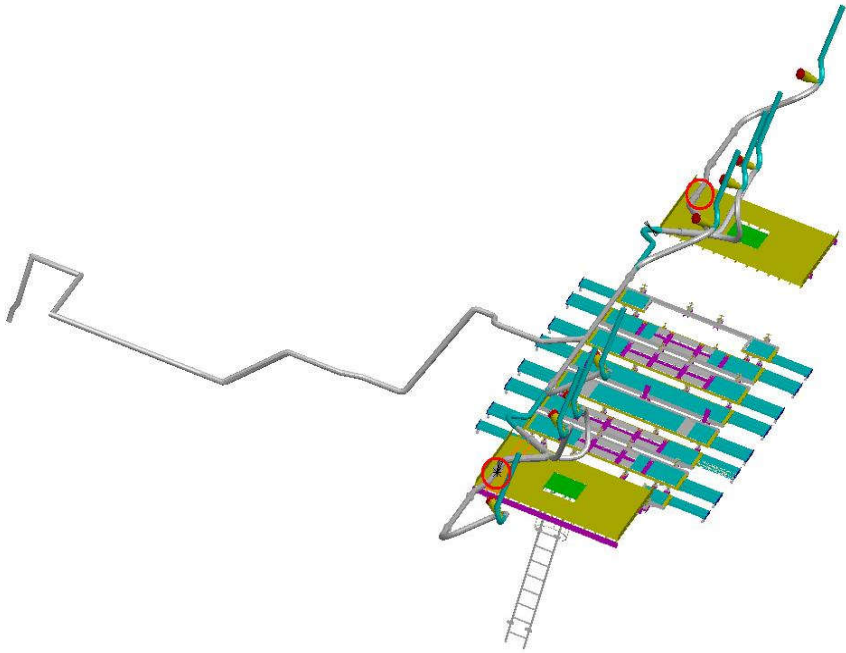

SIDE A and Side C

Sector 13



Clearance Publish

Clearance Computation Specification	
Products Selected	
NSE_0004 - DRAIN PIPE FOR - LAR END-CAP CALORIMETER	VHB_0001 - CENTRAL PAIR OF FEET B - DETAILED MODEL FOR STANDARDS - SIDE A

Computation Result:

NSE__0004	VHB__0001	Clearance	47.2922	Not inspected
-----------	-----------	-----------	---------	---------------

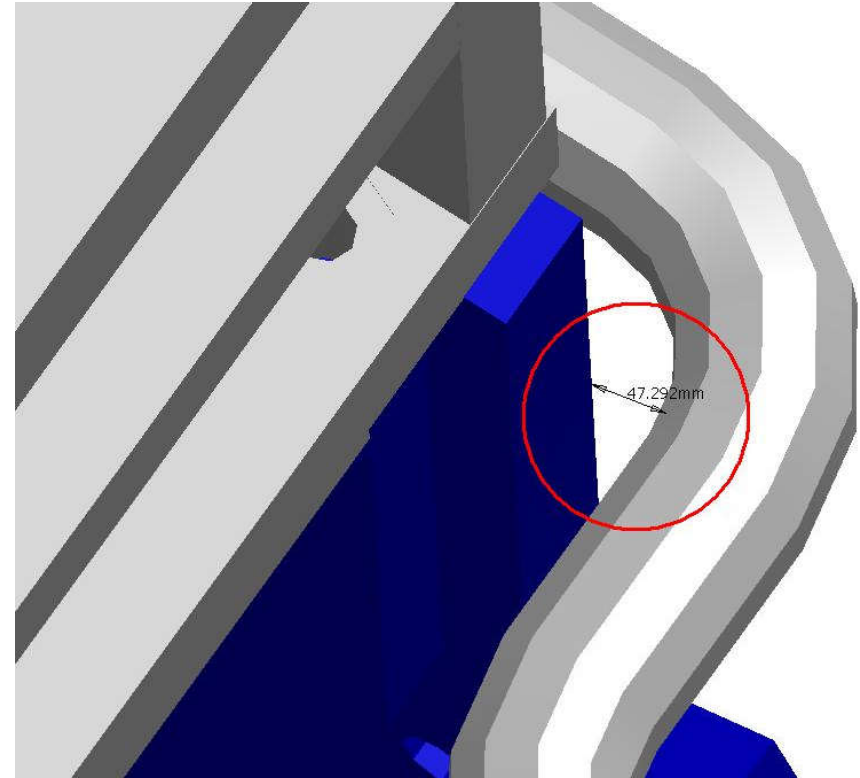
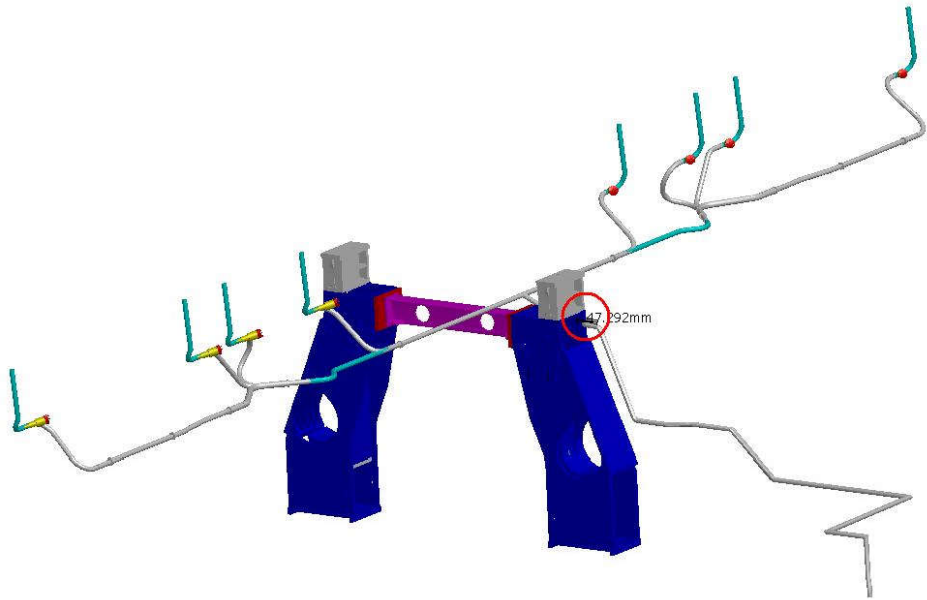

SIDE A

Sector 12



Clearance Publish

Clearance Computation Specification	
Products Selected	
NSE__0004 - DRAIN PIPE FOR - LAR END-CAP CALORIMETER	NLE__0002 - LE END-CAP CALORIMETER - SIDE A - SIDE A

Computation Result:

NSE__0004	NLE__0002	Clearance	13.7271	Not inspected
-----------	-----------	-----------	---------	---------------

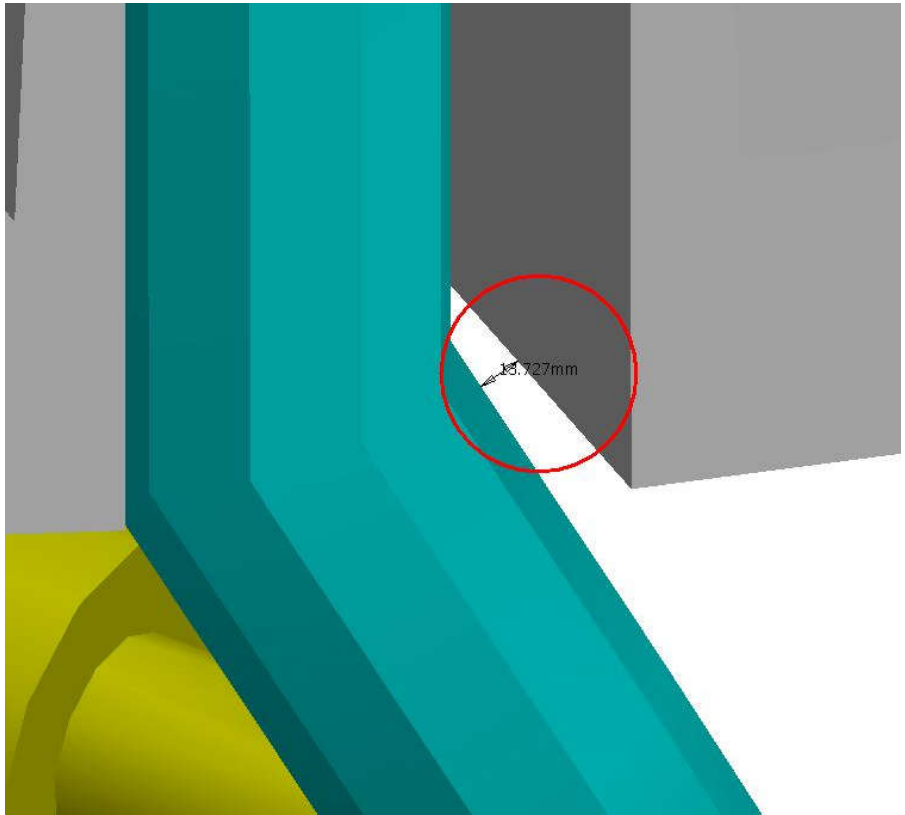
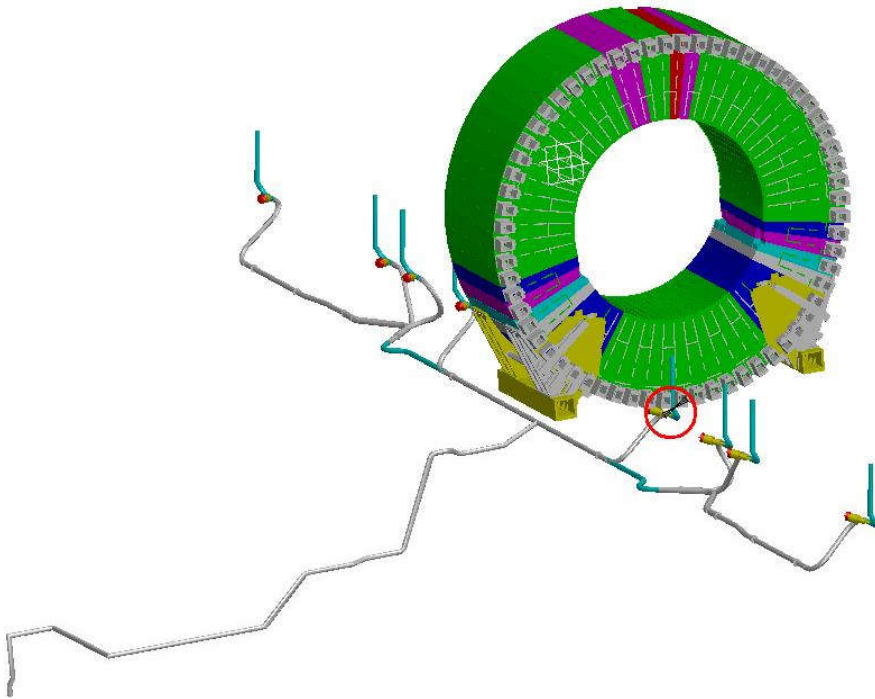

SIDE A
Sector 13



Clearance Publish

Clearance Computation Specification	
Products Selected	
NSE__0004 - DRAIN PIPE FOR - LAR END-CAP CALORIMETER	AT602161MQ - MUON BARREL CHAMBERS DETAILED - SECTOR 11 - SIDE A

Computation Result:

NSE__0004	AT602161MQ	Clearance	92.1256	Not inspected
-----------	------------	-----------	---------	---------------

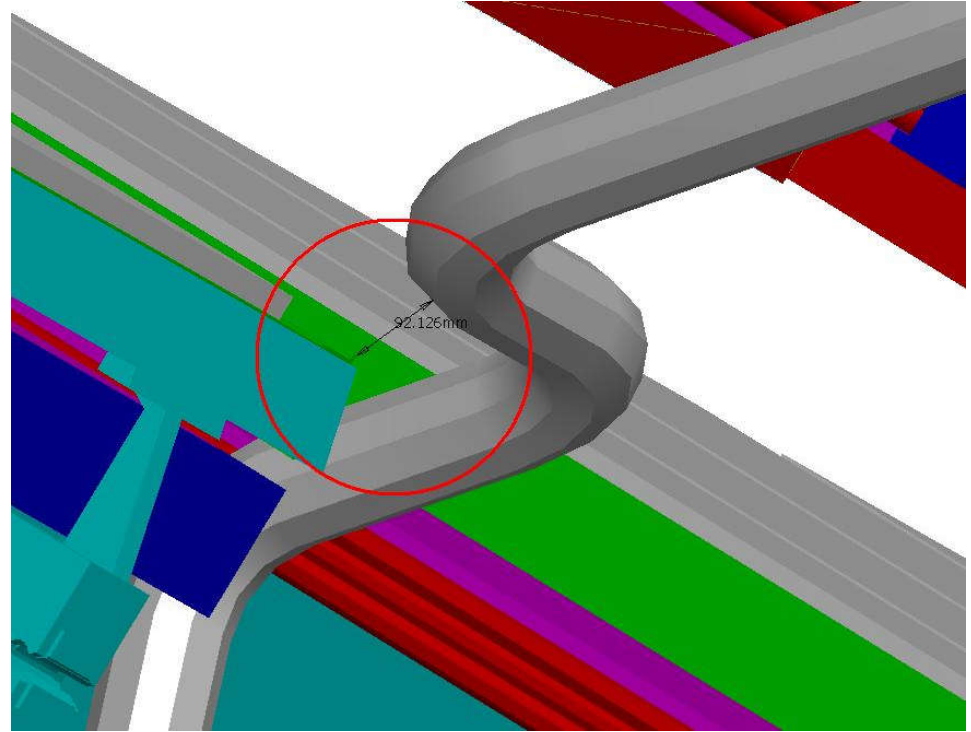
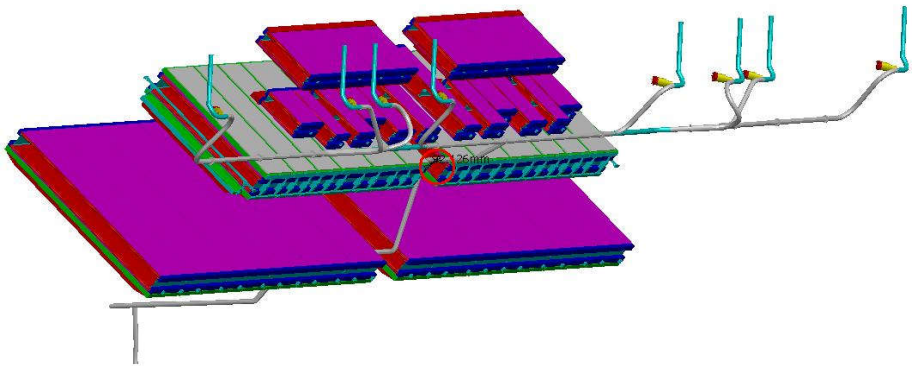

SIDE A
Sector 11



Clearance Publish

Clearance Computation Specification	
Products Selected	
NSE__0004 - DRAIN PIPE FOR - LAR END-CAP CALORIMETER	AT602165MQ - MUON BARREL CHAMBERS DETAILED - SECTOR 13 - SIDE C

Computation Result:

NSE__0004	AT602165MQ	Clearance	16.2975	Not inspected
-----------	------------	-----------	---------	---------------

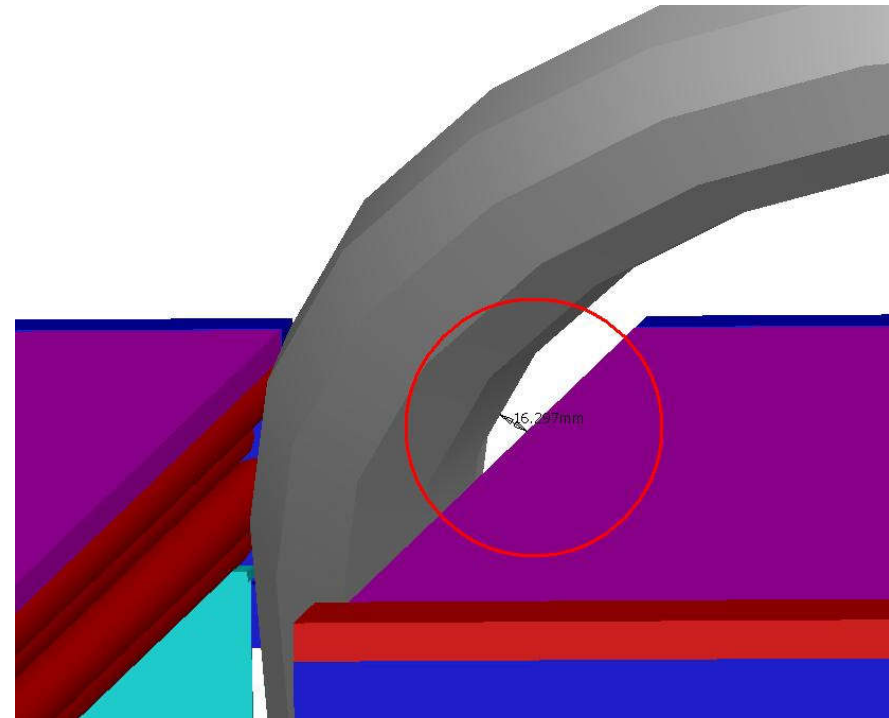
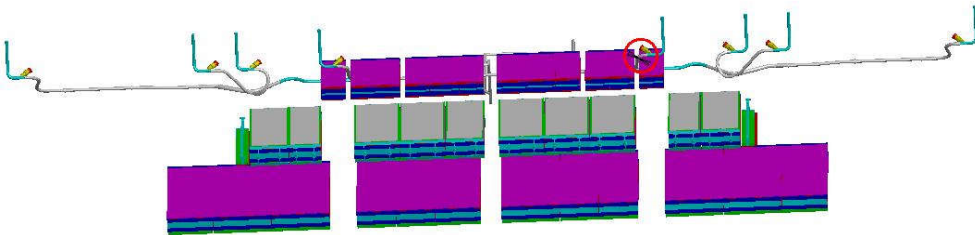

SIDE C
Sector 13



Clearance Publish

Clearance Computation Specification	
Products Selected	
NSE__0004 - DRAIN PIPE FOR - LAR END-CAP CALORIMETER	NMC__0019 - MEE CHAMBERS SIDE C - 3D SIMPLIFIED MODEL - SIDE C

Computation Result:

NSE__0004	NMC__0019	Clearance	15.5054	Not inspected
-----------	-----------	-----------	---------	---------------

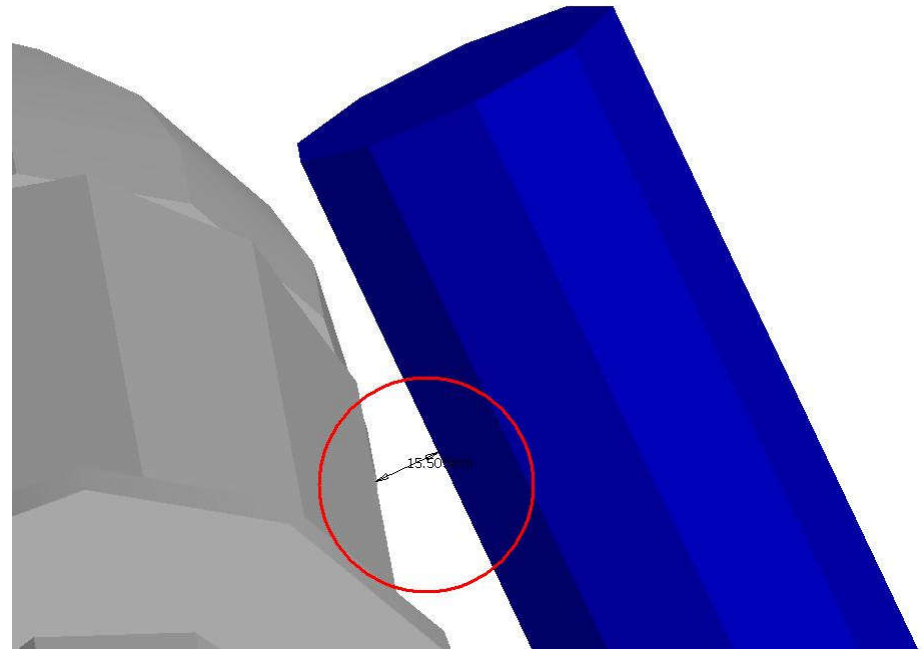
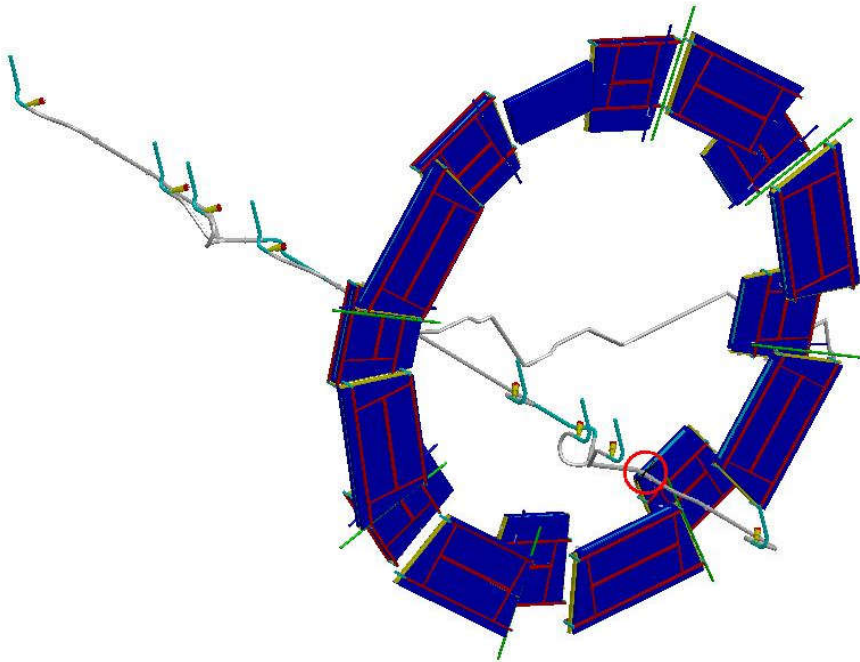

SIDE C
Sector 12



Clearance Publish

Clearance Computation Specification	
Products Selected	
NSE__0004 - DRAIN PIPE FOR - LAR END-CAP CALORIMETER	NMA__0007 - BARREL PROJECTIVE ALIGNMENT. - SIMPLE 3-D MODEL SECTOR 13 - SIDE A-C

Computation Result:

NSE__0004	NMA__0007	Clearance	2.2932	Not inspected
-----------	-----------	-----------	--------	---------------

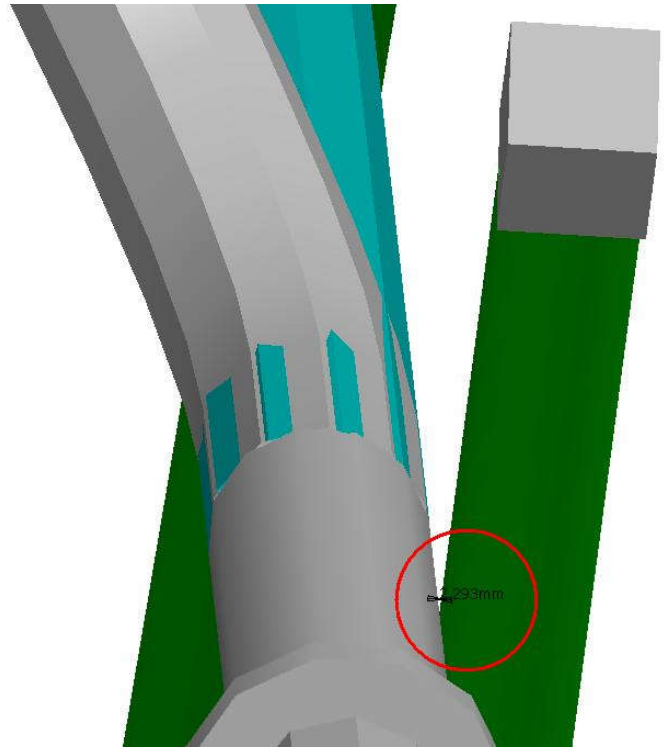
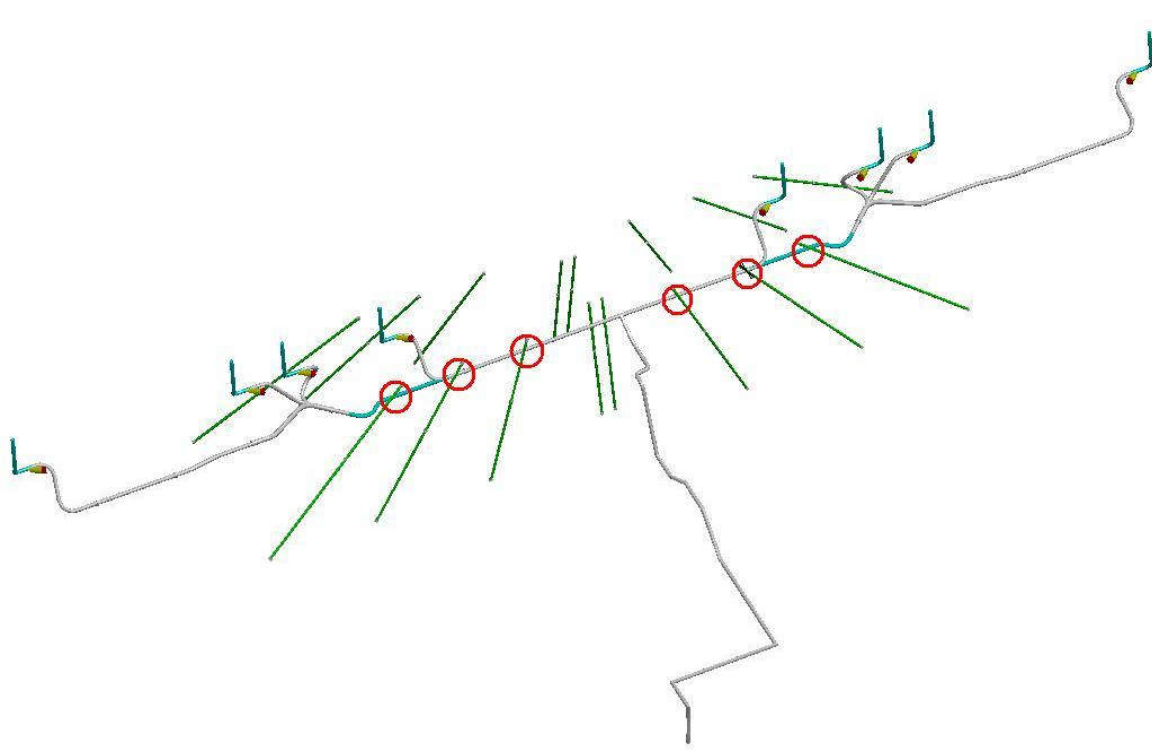

SIDE A-C

6 clearances along Y axis

Sector 12



Clearance Publish

Clearance Computation Specification	
Products Selected	
NSE__0004 - DRAIN PIPE FOR - LAR END-CAP CALORIMETER	NMA__0016 - SECTOR 12 SIDE C (A) - REFERENCE ALIGNMENT SYSTEM AND - SIDE C

Computation Result:

NSE_0004	NMA_0016	Clearance	99.0324	Not inspected
----------	----------	-----------	---------	---------------

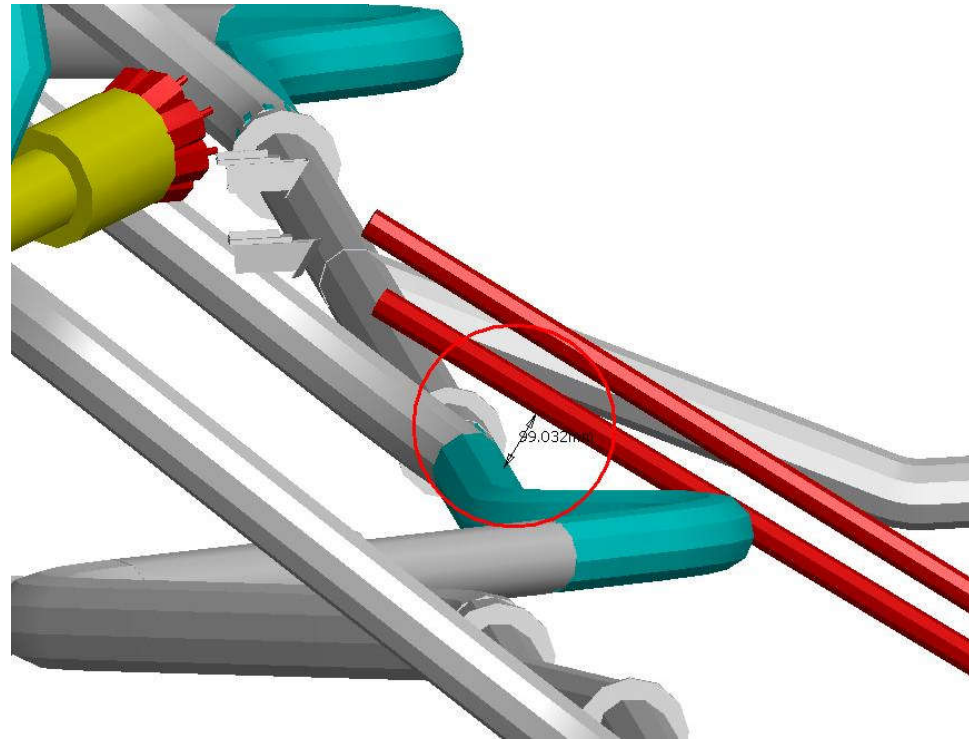
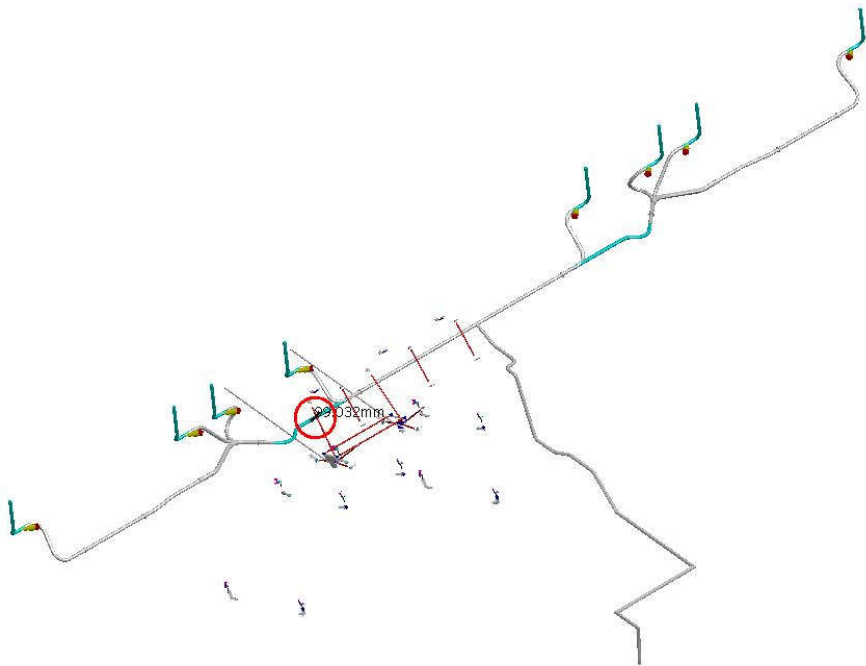

SIDE C
Sector 12



Clearance Publish

Clearance Computation Specification	
Products Selected	
NSE__0004 - DRAIN PIPE FOR - LAR END-CAP CALORIMETER	NSB__0008 - BARREL LAR BOTTOM FT VACUUM LINES - SIMPLIFIED 3D OBJECT - SIDE C

Computation Result:

NSE__0004	NSB__0008	Clearance	49.46	Not inspected
-----------	-----------	-----------	-------	---------------

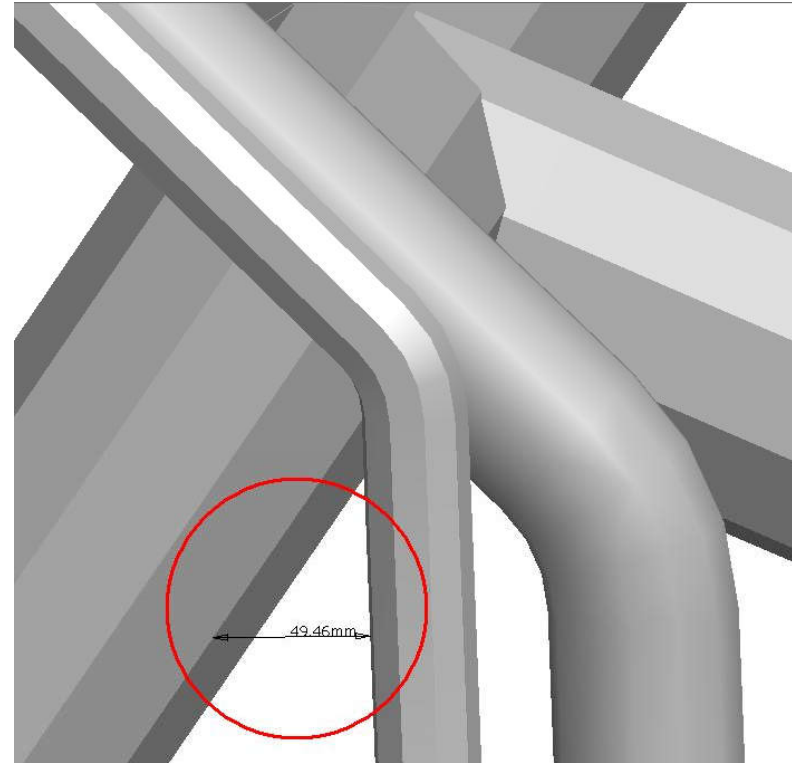
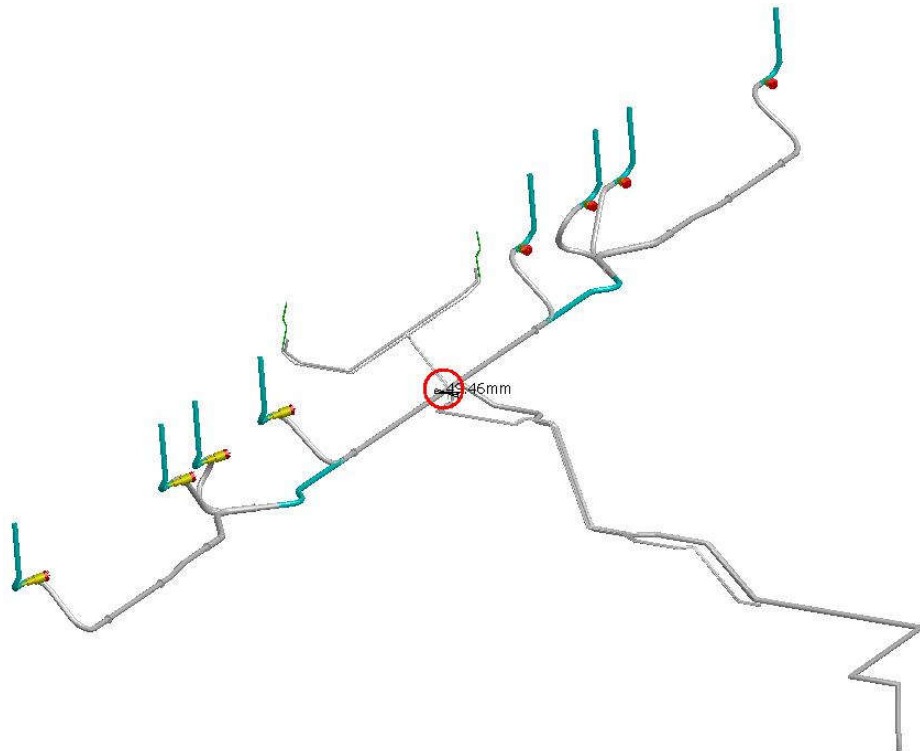

SIDE C
Sector 12



Clearance Publish

Clearance Computation Specification	
Products Selected	
NSE__0004 - DRAIN PIPE FOR - LAR END-CAP CALORIMETER	NSR__0005 - CABLE TRAYS - FOR TB VACUUM PUMPING SYSTEM - SIDE A-C

Computation Result:

NSE_0004	NSR_0005	Clearance	71.9698	Not inspected
----------	----------	-----------	---------	---------------

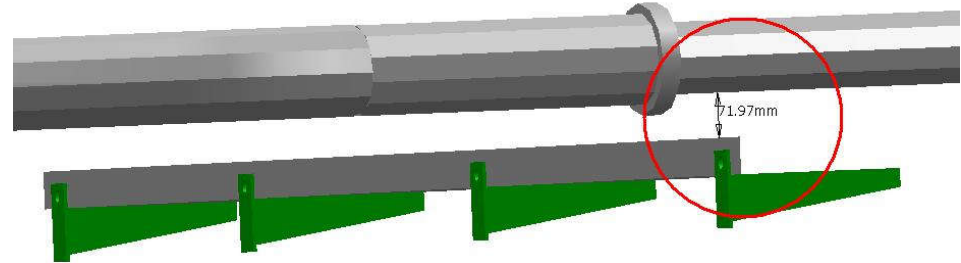
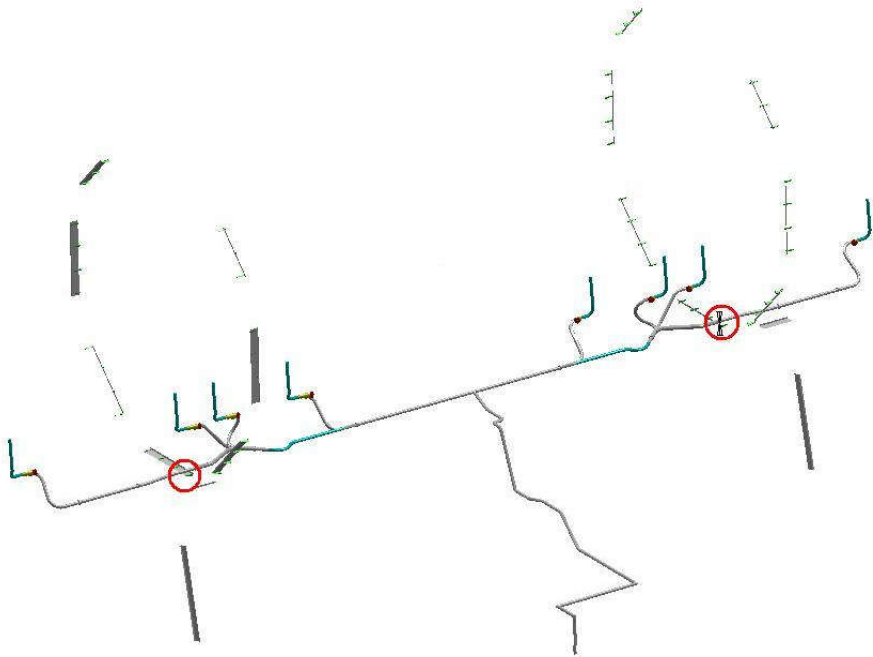

SIDE A-C

2 clearances along Y axis

Sector 13



Clearance Publish

Clearance Computation Specification	
Products Selected	
NSE__0004 - DRAIN PIPE FOR - LAR END-CAP CALORIMETER	NTB__0003 - TB WARM STRUCTURE - SIMPLIFIED 3-D OBJECT - SIDE A-C

Computation Result:

NSE__0004	NTB__0003	Clearance	49.6854	Not inspected
-----------	-----------	-----------	---------	---------------

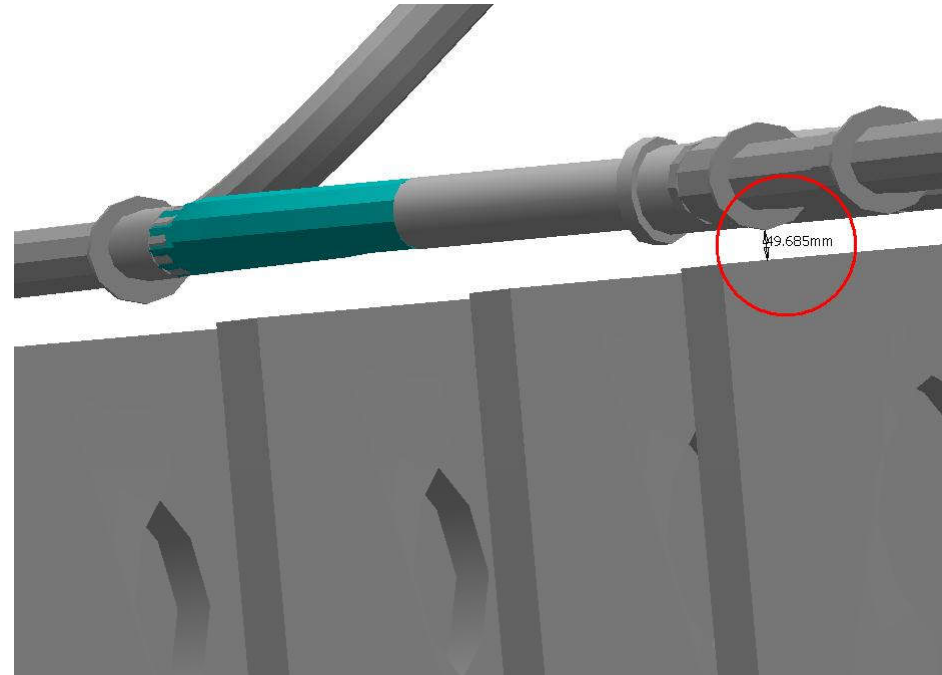
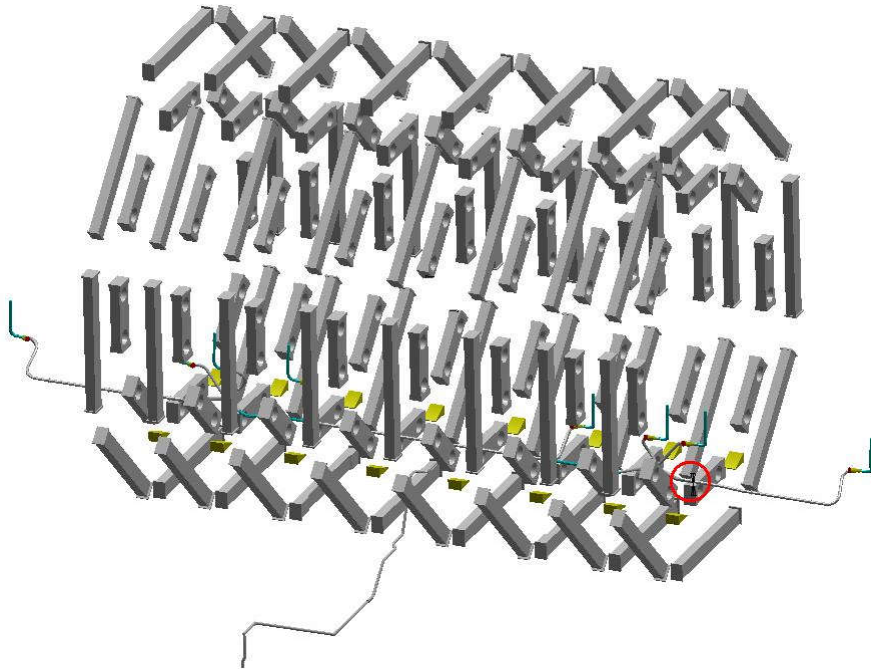

SIDE A-C

8 clearances along Y axis

Sector 13



Clearance Publish

Clearance Computation Specification	
Products Selected	
NSE__0004 - DRAIN PIPE FOR - LAR END-CAP CALORIMETER	NTB__0005 - TB WARM STRUCTURE - RING OF THE VOUSOIRS, STRUTS - SIDE C

Computation Result:

NSE_0004	NTB_0005	Clearance	77.7701	Not inspected
----------	----------	-----------	---------	---------------

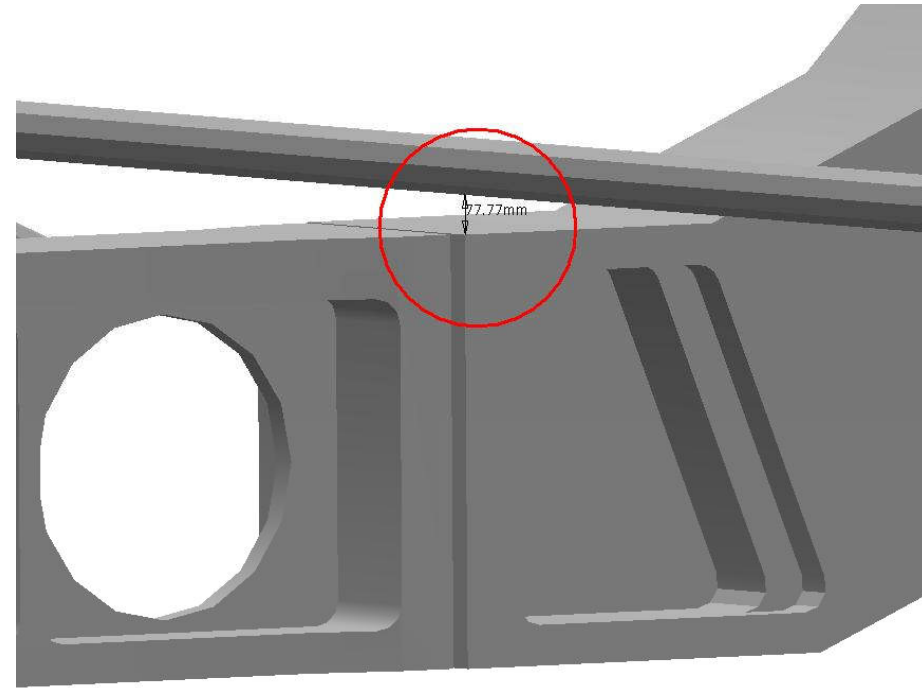
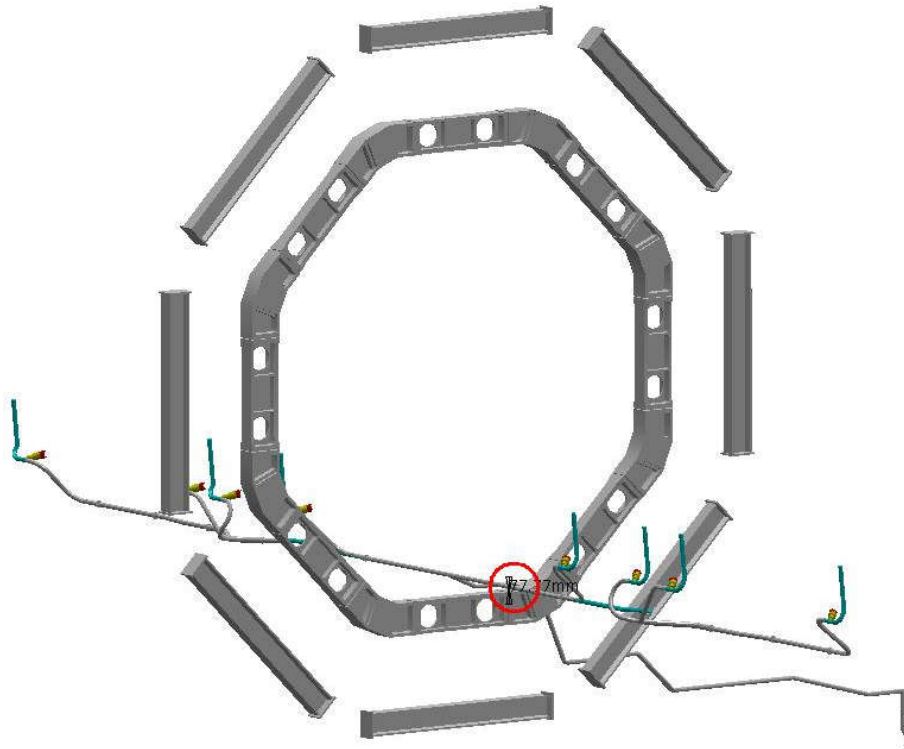

SIDE C
Sector 13



Clearance Publish

Clearance Computation Specification	
Products Selected	
NSE__0004 - DRAIN PIPE FOR - LAR END-CAP CALORIMETER	NTB__0002 - TB FEET COIL - SECTOR 12 - SIDE C

Computation Result:

NSE__0004	NTB__0002	Clearance	6.0451	Not inspected
-----------	-----------	-----------	--------	---------------

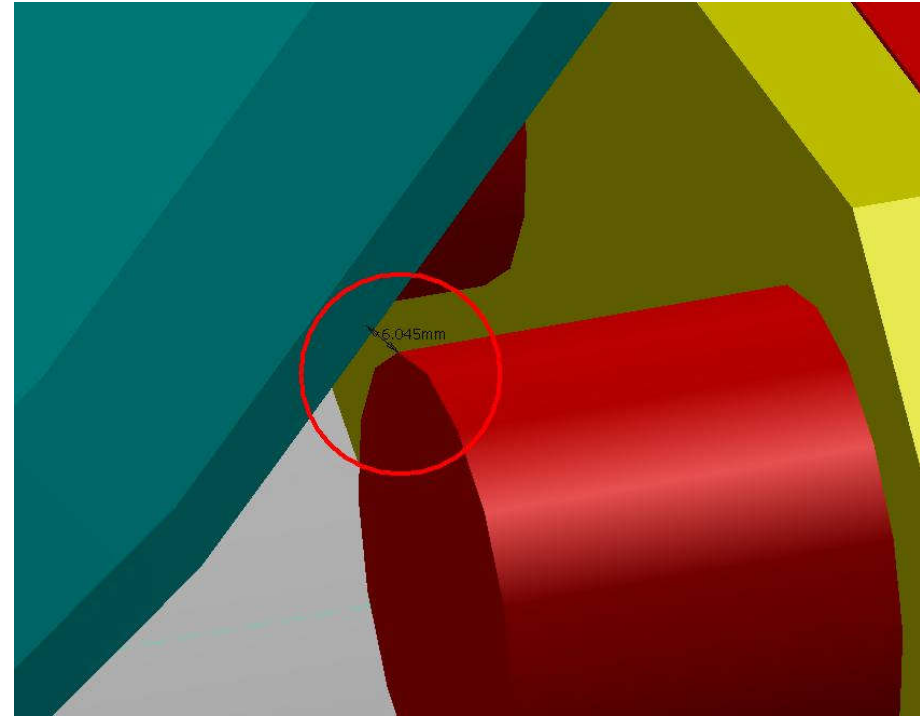
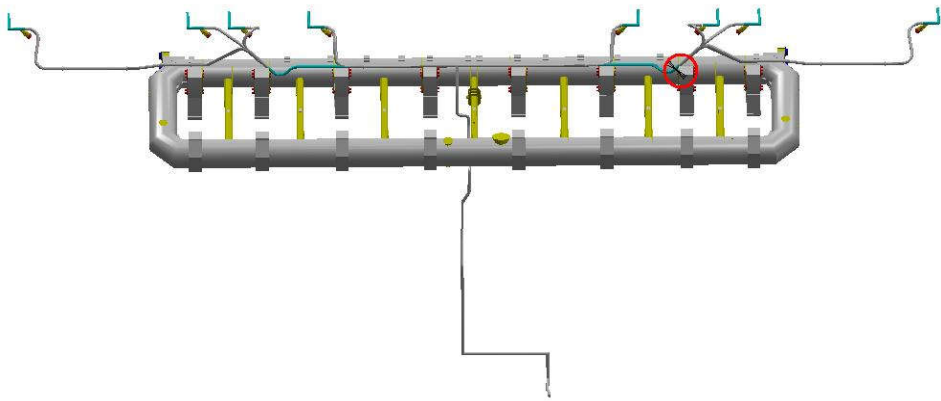

SIDE C
Sector 12